

105

5001 Yonge St.

Toronto, ON

BASIC RENT
\$20.00

ADDITIONAL RENT
\$20.87

GROSS COST PER SF
\$40.87

COST PER MONTH
\$2,407.92

SUITE DETAILS

MIN DIVISIBLE
No

MAX CONTIGUOUS
707 SF

UNIT TYPE
Retail

SQUARE FEET
707 SF

FLOOR
1

AVAILABILITY
Immediate

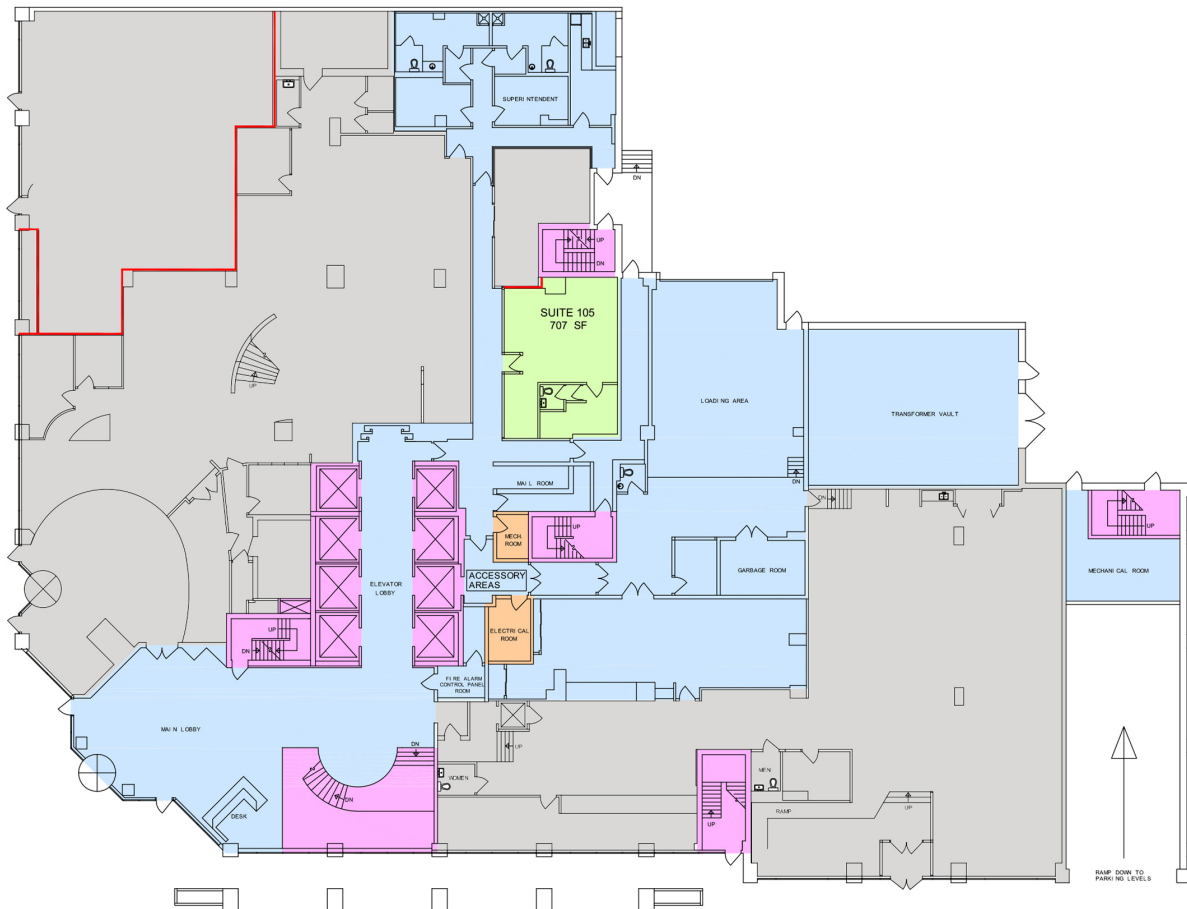

- USABLE AREA
- VERTICAL PENETRATIONS
- FLOOR COMMON AREA
- BUILDING COMMON AREA
- DEMISING WALL

0 10 50 FT.

